

Patio Door & Side Panel
Installation & Assembly

Installation Procedures:

1. Slide Door Panel to passive side, lower with adjustable rollers and remove. Uninstall panel track (pry tool recommended) and anti-lift bar.
2. If received separately, align & assemble Side Panel(s) with Door utilizing provided screws (#3). Use all prefabricated #3 screw locations.
3. Attach and seal provided joining couplers to both sides of the frames with silicone.
4. With #4 screws, attach End Plate to top end of frame connection. Make sure the installation holes for screws #1 & #2 align with corresponding slots on End Plate. Seal End Plate around its perimeter with silicone.
5. Make sure opening is in good size & condition. Clean & repair if necessary. Locate Door Assembly depth position inside wall opening.
6. Make sure that min. ¼" joint between Door Frame and wall cladding elements is maintained around entire perimeter. To finish the joint, use backer rod ~30% larger than the joint and seal it with appropriate caulking, allowing for at least 25% cured joint movement.
7. Inspect and level Door Threshold location. Install applicable flashing system (provided by others).
8. The Door Threshold must be supported in a straight and level position to prevent sagging, deflections and rotation. If Door Threshold & Side Panel Sill need to be shimmed to compensate for uneven sub-floor, use non-porous shims at max 12" o.c. to properly distribute Door & Side Panel weight across the sub-floor. The shims need to be fastened into the sub-floor. Insulate and seal gaps between Door & Side Panel frames and opening.
9. If Threshold is to be sealed to the sub-floor, apply at least 2 continuous ⅝" beads of glue or silicone, jamb to jamb.
10. Apply silicone to all possible contact areas between exterior side of Door Assembly and wall opening.
11. Position and shim Door Assembly into opening. Make sure Assembly remains level, square and plumb, frame elements remain straight & in line.
12. If Door Assembly includes nail fin, apply bead of silicone between nail fin and external wall surface. Temporary use of fasteners on nail fin is allowed, but these need to be removed after installation screws are in place. Flash installed Door Assembly with dedicated product, starting at Threshold, continuing along sides and finishing on header (follow standard practices). Make sure the flashing is covered with exterior wall surface within a time frame recommended by the flashing manufacturer.
13. Fasten installation screws in prefabricated locations. Make sure gaps at installation screw locations are filled with shims and that tightly fastened screws don't deform frame elements. Frame profiles must remain straight, not twisted. Do not use any shims on Door Assembly header and lintel. If any installation screws need to be fastened through Threshold, it is installer's responsibility to fabricate recommended installation holes in recommended locations. The screw passages need to be plugged and sealed with silicone. Special attention is required to prevent any leak from threshold into the sub-floor.
14. Reinstall Door Panel track & Door Panel. Raise Door Panel with adjustable rollers. Make sure the Door Jamb and Door Panel are parallel. Adjust rollers again if necessary.
15. Move Door Panel completely to passive side, reinstall anti-lift bar, check if Panel moves freely, adjust with rollers if needed.
16. Install Lock Striker Plate(s) in pre-drilled location(s), adjust position if necessary.
17. Slide Door Panel to leave not more than 4" opening, position Secondary Lock Striker against pre-installed Secondary Lock and fasten into Door frame. Check for proper functioning.
18. Install supplied bumpers and snap provided track cover into Door frame.
19. Finish interior and exterior Door Assembly perimeters as per project specifications.

Section 1-1

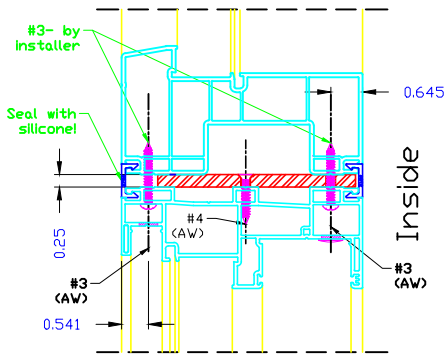

Side Panel Header
& End Plate

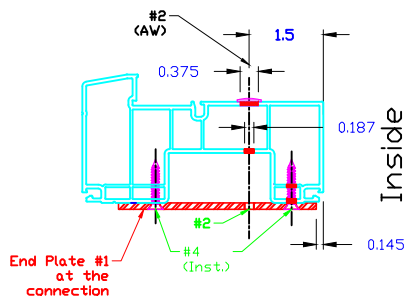

Section 2-2
Fabrication

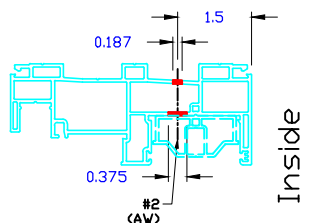

Door Threshold

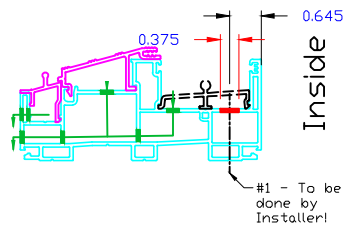

Section 3-3
Fabrication

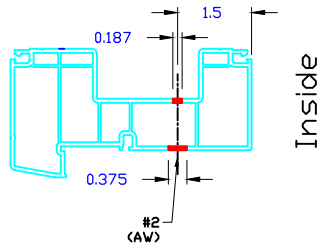

Side Panel Sill
Fabrication

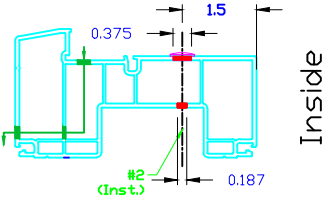

Section 4-4

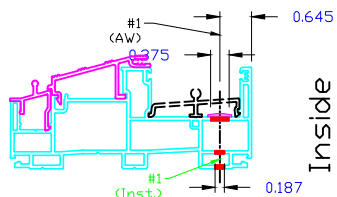

Sliding Door W/Side Panel(s)
Installation Diagram

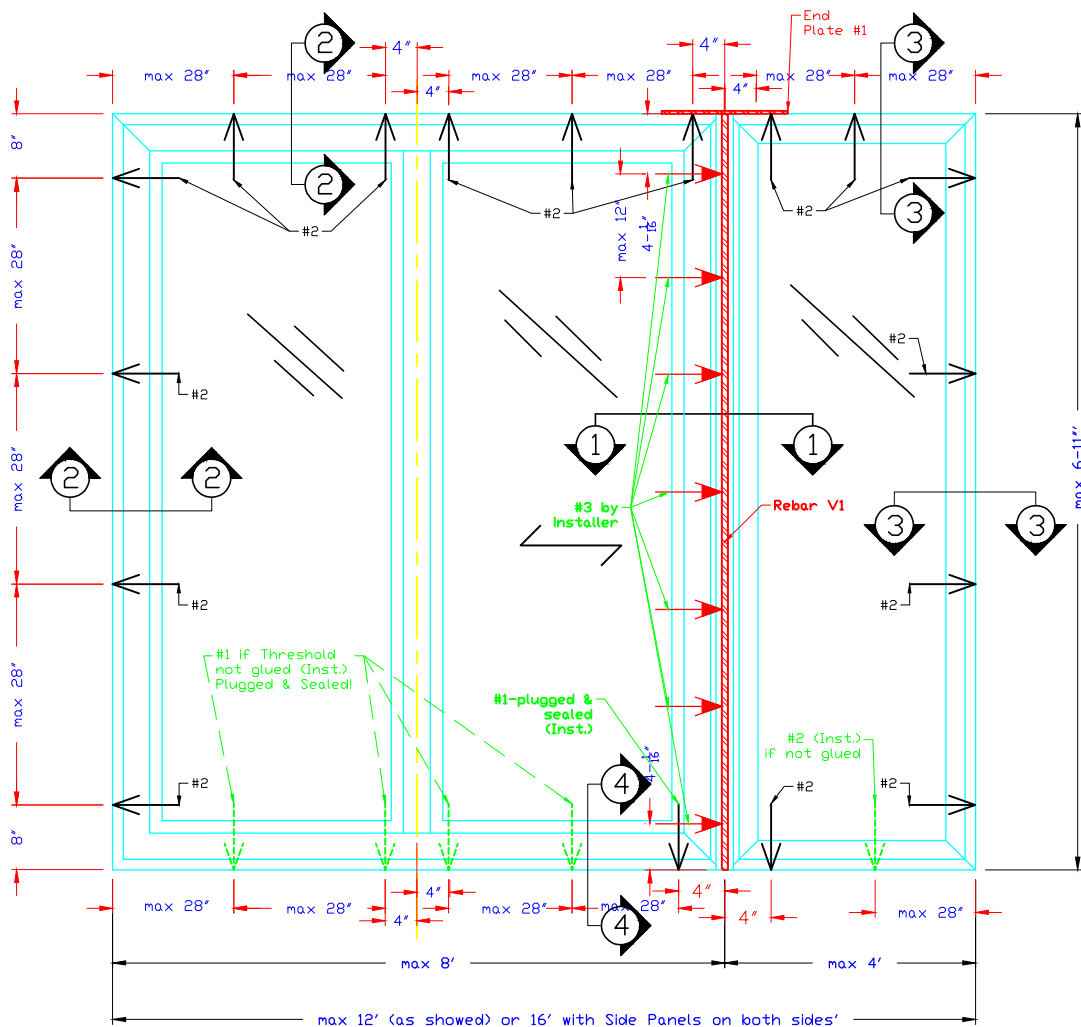

Screw list:

- | | |
|----------|------------------------|
| 1. #1 | - #10 x 2.50" Pan Head |
| 2. #3 | - #8 x 1.25" Pan Head |
| 3. #4 | - #8 x 1.00" Flat Head |
| 4. #5 | - #8 x 1.00" Pan Head |

Advanced Window Corp

4935 W. Le Moyne St
Chicago, IL 60651

10/06/20